

FROM HOME TO HOSPITAL TO HEALTH

LOCATION-BASED SERVICES
FOR HEALTHCARE

Wayfinding with Phunware and Mist

Faced with increasing pressure to improve patient experience, hospitals are turning to mobile to help them make a difference where it matters most: with wayfinding and communication right inside the facility. Phunware's mobile solutions leverage native smartphone features and location technology to empower hospitals to engage patients on their phones in real time.

PHUNWARE MOBILE WAYFINDING APPLICATION

Phunware's brandable, ready-for-market hospital mobile app includes:

1. Healthcare-specific mobile UI templates
2. Directories of doctors and departments
3. Mapping, navigation and wayfinding*
4. Alerts and notifications*
5. In-app promotions*
6. Marketing automation*
7. App analytics and business intelligence*

**Also licensable a-la-carte*

PHUNWARE MAP EDITOR PORTAL

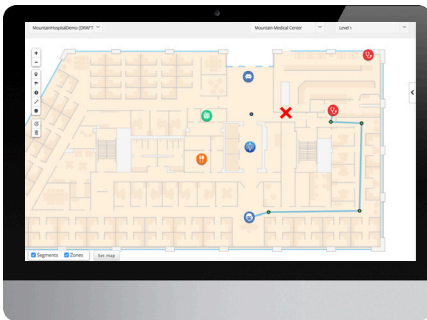

Manage and update application maps and points of interest with Phunware's web-based map editor. Changes like construction detours, staff-only areas and facility closures can be made in the portal and pushed live to the app without re-submitting to the App Store or Google Play.

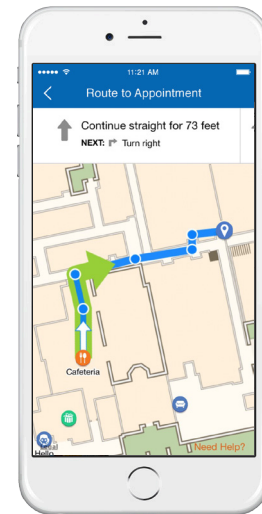

Mapping, navigation and wayfinding

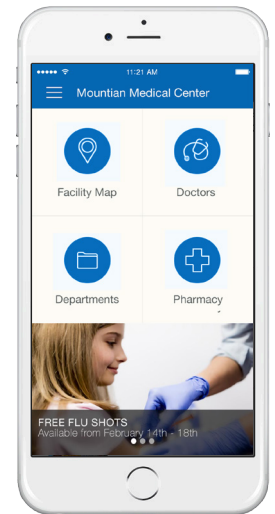

Healthcare-specific mobile UI templates

MIST LOCATION SERVICES

The Mist wireless platform was designed from the ground up to handle the unique wireless needs of the smart device era. It combines cloud intelligence with on-premise access points to simplify wireless operations and deliver high-value location services via Wi-Fi and Bluetooth Low energy (BLE). Unique advantages of the Mist BLE solution include:

High-accuracy location: Mist offers 1-3 meter location accuracy (the best in the industry) and sub-second latency in most environments. Machine learning eliminates the need for BLE site surveys and provides the best user experience.

Virtual beacons: With Mist's patented vBLE technology, you can deploy an unlimited amount of virtual beacons for proximity messaging with the simple click of a mouse. There is no need to purchase, deploy and manage separate physical beacons with batteries, eliminating headaches and up to 90% of BLE hardware costs.

Proactive insight: The Mist platform tracks user activity for detailed record keeping, asset tracking and behavior analysis.

Open APIs: Mist offers a mobile SDK for iOS and Android with three types of APIs for seamless integration with complementary products, such as Phunware mobile applications.

PHUNWARE.COM/SOLUTIONS/HEALTHCARE
MIST.COM/PRODUCT

healthcare@phunware.com | 855.521.8485

© 2016 PHUNWARE, INC. ALL RIGHTS RESERVED.



FROM HOME TO HOSPITAL TO HEALTH

LOCATION-BASED SERVICES
FOR HEALTHCARE

Wayfinding with Phunware and Mist

**Phunware wayfinding + Mist vBLE infrastructure =
Facility-wide routing with real-time guidance**

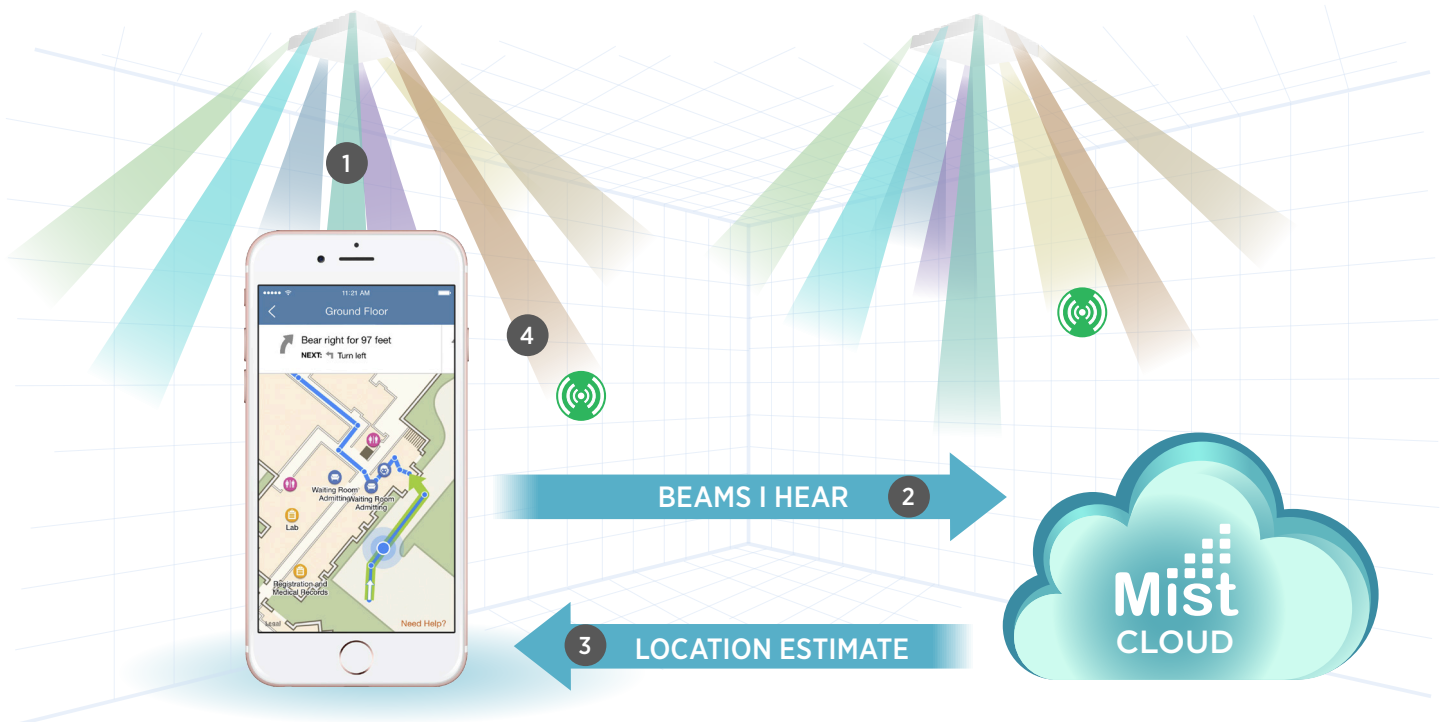

HOW PHUNWARE AND MIST WORK TOGETHER

- 1** A Mobile device listens to the BLE beacons from a Mist access point.
- 2** The Mist SDK sends the device location information to the Mist cloud.
- 3** The Mist cloud sends location and map information to the Phunware mobile application and provides real-time updates.
- 4** Virtual beacons can be created anywhere and enable proximity-based messages to be delivered in the Phunware application.



PHUNWARE.COM/SOLUTIONS/HEALTHCARE
MIST.COM/PRODUCT

healthcare@phunware.com | 855.521.8485

© 2016 PHUNWARE, INC. ALL RIGHTS RESERVED.

9040245-001-EN-Mar 2016